



## SBS6028H SERIES ~ SMD Shielded Power Inductors



### PART NUMBERING SYSTEM

<b>SBS</b>	<b>6028H</b>	—	<b>150M</b>	—	<b>LF</b>
TYPE	DIMENSIONS		INDUCTANCE		LEAD FREE

### SHAPES AND DIMENSIONS

UNIT : mm

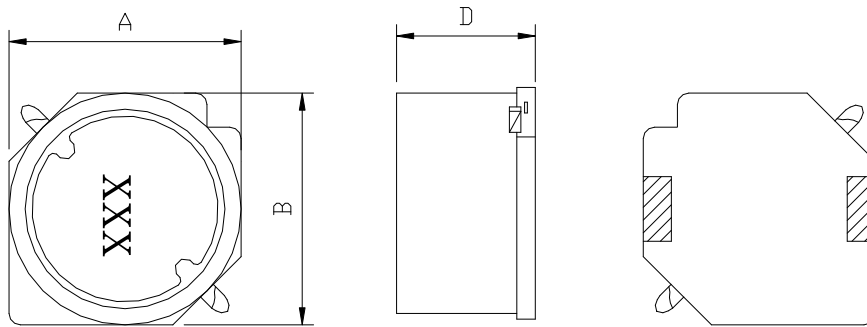

A=6.2 Max. B=6.2 Max. D=3.0 Max.

### RECOMMENDED PATTERNS

UNIT : mm

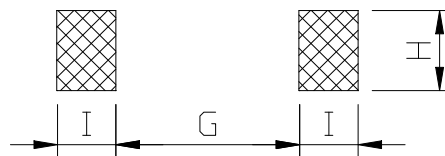

G=4.0 H=2.2 I=1.5

### FEATURES

- High rated current, low DC resistance .
- Magnetically shielded construction .
- Suitable for lead-free reflow soldering as referenced in JEDEC J-STD 020D .
- Ideal for a variety of DC-DC converter inductors applications .
- RoHS compliant .

## SBS6028H SERIES ~ SMD Shielded Power Inductors



### SPECIFICATION TABLE

PART NUMBER	INDUCTANCE ( $\mu$ H)	DCR ( $\Omega$ ) (Max.)	Isat (A) ( Max. )	Irms (A) ( Max. )	TEST FREQ. ( f )
SBS6028H-R82M-LF	0.82 $\pm$ 20%	0.015	4.45	3.45	100KHz
SBS6028H-1R0M-LF	1.0 $\pm$ 20%	0.016	4.40	3.40	100KHz
SBS6028H-1R2M-LF	1.2 $\pm$ 20%	0.017	3.90	3.25	100KHz
SBS6028H-1R5M-LF	1.5 $\pm$ 20%	0.020	3.60	3.10	100KHz
SBS6028H-2R2M-LF	2.2 $\pm$ 20%	0.025	2.60	2.55	100KHz
SBS6028H-3R3M-LF	3.3 $\pm$ 20%	0.031	2.10	2.30	100KHz
SBS6028H-4R7M-LF	4.7 $\pm$ 20%	0.040	1.80	2.00	100KHz
SBS6028H-6R8M-LF	6.8 $\pm$ 20%	0.050	1.50	1.65	100KHz
SBS6028H-100M-LF	10.0 $\pm$ 20%	0.062	1.30	1.50	100KHz
SBS6028H-150M-LF	15.0 $\pm$ 20%	0.097	1.05	1.25	100KHz
SBS6028H-220M-LF	22.0 $\pm$ 20%	0.150	0.85	1.05	100KHz
SBS6028H-330M-LF	33.0 $\pm$ 20%	0.230	0.72	0.85	100KHz
SBS6028H-470M-LF	47.0 $\pm$ 20%	0.310	0.60	0.75	100KHz
SBS6028H-680M-LF	68.0 $\pm$ 20%	0.410	0.50	0.65	100KHz
SBS6028H-101M-LF	100 $\pm$ 20%	0.580	0.42	0.53	100KHz
SBS6028H-151M-LF	150 $\pm$ 20%	1.050	0.33	0.38	100KHz
SBS6028H-221M-LF	220 $\pm$ 20%	1.350	0.28	0.35	100KHz
SBS6028H-331M-LF	330 $\pm$ 20%	2.300	0.22	0.27	100KHz
SBS6028H-471M-LF	470 $\pm$ 20%	2.700	0.18	0.24	100KHz
SBS6028H-681M-LF	680 $\pm$ 20%	4.050	0.15	0.20	100KHz
SBS6028H-102M-LF	1000 $\pm$ 20%	6.000	0.13	0.16	100KHz

- Isat : DC current at which the inductance drops 10% (typ) from its value without current.
- Irms: The actual current when temperature of coil becomes  $\Delta 40^{\circ}\text{C}$ . (  $T_a = +25^{\circ}\text{C}$  )
- Operating temperature range  $-40^{\circ}\text{C}$  to  $+125^{\circ}\text{C}$  ,
- Electrical specifications at  $25^{\circ}\text{C}$ .
- Packing : Tape & reel ; 1,000pcs / Reel.